

# CROWN LINK®

專業薄膜開關連接器第一品牌

ROHS

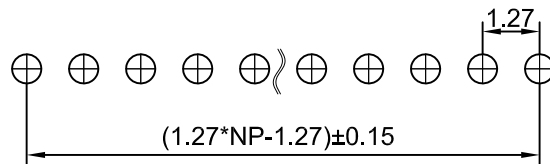
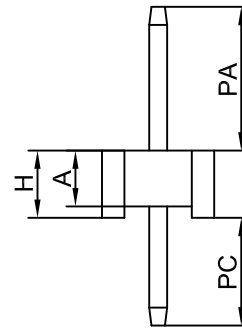
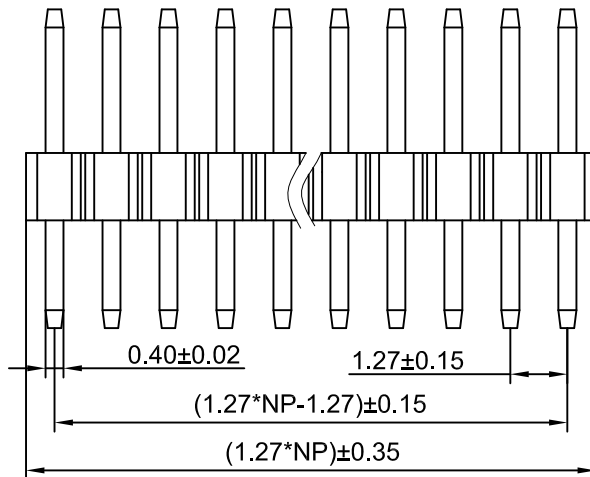
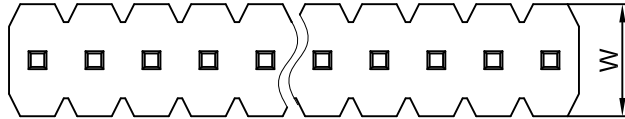
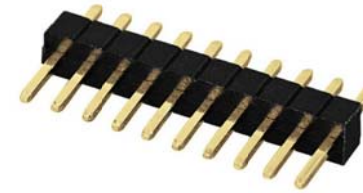

PCB LAYOUT

### ◆ Specifications

- 1.Current Rating:1Amps
- 2.Insulation Resistance:1000 MΩ min
- 3.Dielectric withstanding Voltage: AC 500V
- 4.Contact Resistance:30 mΩ max
- 5.Operating Temperature:-25°C to+85°C
- 6.Contact Material: Brass
- 7.Insulation Material:As follows
- 8.Plated: As follows

### ◆ PART NO.

L203 XX -XX 0 X X XX X

1.27mm single row	PLASTIC HEIGHT HW	PIN NO. 1~50	0=180° 1=90°	MATERIAL 1、PBT 2=SMT 3、NY6T 4、LCP 5、NY66 7、NY46 8、NY9T	PLATED 0、Au0,8u" 1、Au1u" 2、Au1.5u" 3、Au2u" 4、Au3u" 5、Au5u" 6、Au10u" 7、Selective gold 8、Tin 9、Matte-Tin	SERIES NO. 01~69:Without a column 70~99:With inside column	PACKAGE A=bag B=tubes C=tray D=reel
06=0.65*2.5	10=1.0*2.0	15=1.5*2.0	15=1.5*2.5	17=1.7*2.5	20=2.0*2.5	25=2.54*2.5	

				LINER	ANGLES
				.0 ±0.30	0.° ±2°
A	FIRST DRAWING	MARY	2017.08.30	.00 ±0.20	.0° ±1°
REV/版本	MODIFIED CONTENT /變更內容	DRAWN/繪圖	DATE/日期	.000 ±0.10	.00° ±0.5°
				TOLERANCE RANGE/公差範圍	

DRAWN/繪圖 MARY 2017.08.30	DATE/日期 2017.08.30	<b>CROWN LINK® THE LEADING MANUFACTURER OF FPC &amp; FFC CONNECTOR, HOUSING AND DOME.</b>			
CHECK BY/審查 VIVIAN 2017.08.30	DATE/日期 2017.08.30	PRODUCT NAME/品名 PH1.27*H 1×NP 180° SINGLE ROW PIN HEADER			
APPROVED BY/核准 WENDY 2017.08.30	DATE/日期 2017.08.30	PART NO./料號 L203XX-XX0XXXXX	PIN NUMBER/針數 01P-50P	SCALE/比例	SIZE/圖號 A4
PACKAGE/包裝		MATERIAL/材質 BLACK COLOR	COLOR/顏色	ANGLE OF VIEW/視角 	UNIT/單位 mm
				SHEET/頁碼 1 OF 1	REV/版本 A